

Balmain

101/2A Rowntree Street



\$1.5m

Art Deco elegance meets cutting-edge design

A collaboration between MADE Property Group and SJB, the creative reinvention of the former Bijou Theatre strikes a perfect chord between Art Deco elegance and cutting-edge design in the heart of Balmain village. Set on the first floor with views to the Harbour Bridge from a loggia-style balcony, this two-bedroom apartment captures the essence of contemporary luxury with cosmopolitan dining, shopping and pub culture at the doorstep. Limestone floors and marble finishes create a sophisticated feel designed to reflect contemporary urban lifestyles.

- Award-winning revival of an historic theatre and music hall
- Secure level lift access, video intercom and a courtyard entry
- 2 large bed with built-ins, master suite with a walk-in robe
- Entertainer's marble island gas kitchen, Smeg appliances
- Bright open living and dining, limestone floors, ducted air
- Loggia-style balcony, district views to the Harbour Bridge

2



2

ADDITIONAL DETAIL

Council Rates	\$230/qtr (approx)
Strata Fees	\$1,320/qtr (approx)
Water Rates	\$153/qtr (approx)
Type	Apartment
Sold Date	30/10/2020

Rosemary Chen
0414 766 743
rosemary@ch.com.au

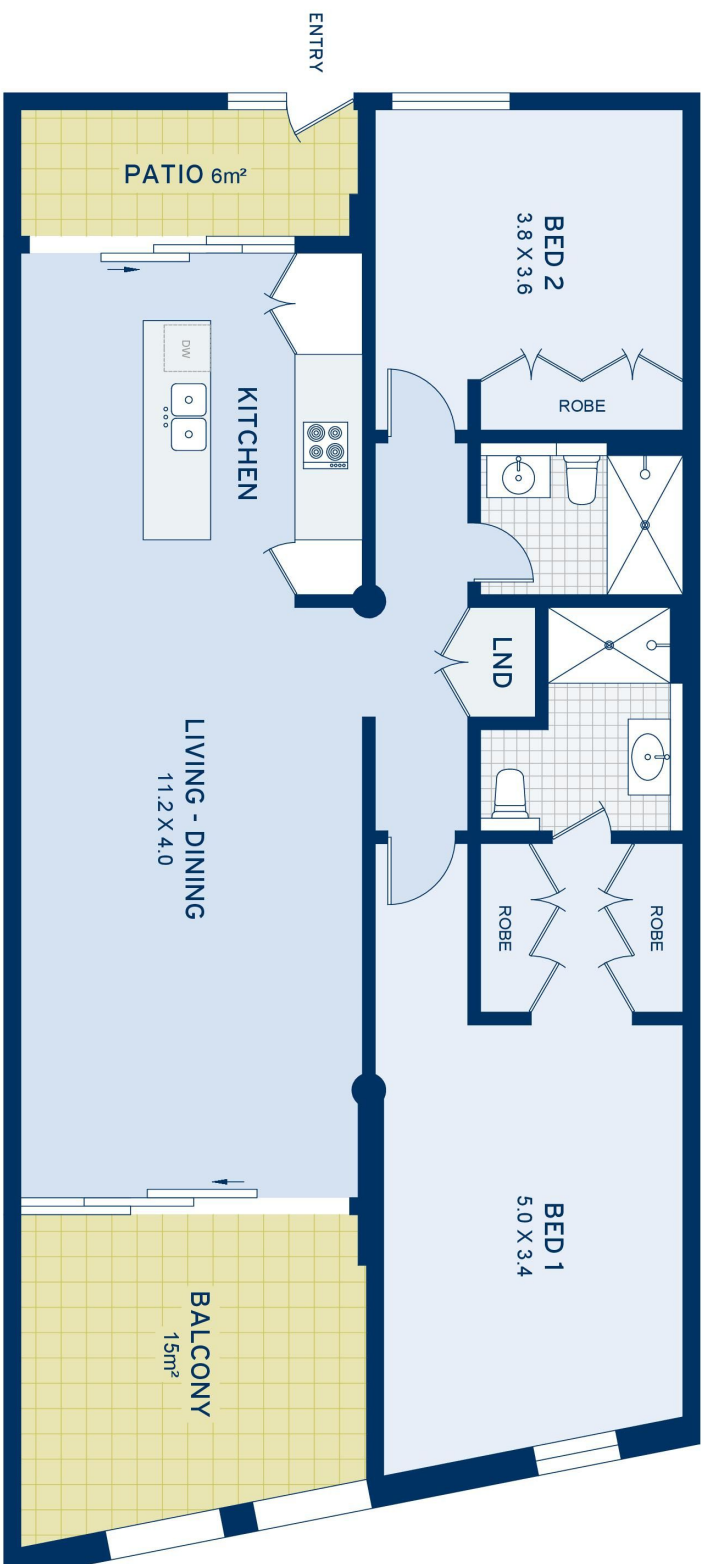
Matthew Hayson
0411 519 190
matth@ch.com.au



APPROXIMATE AREAS	
Internal FloorSpace	96sqm
External	21sqm
Total	117sqm
OUTGOINGS	
Council Rates	\$230 pq
Water Rates	\$153 pq
Strata Rates	\$1320 pq

Balmain
101/2A Rowntree Street

DISCLAIMER: This information has been prepared as a guide only. The vendor and the real estate agent, Balmain Real Estate Pty Ltd and/or Balmain Estate Agency Pty Ltd (trading as Cobden & Hayson Balmain), make no warranties as to its accuracy and all interested parties must rely on their own enquiries.

cobden & hayson