

Drummoyne

310/2 Marlborough Street



\$860k

Stylish custom interiors and dazzling views

Holding a prized corner setting in the exclusive Odeon Apartments, this custom-renovated apartment offers unbeatable convenience at the gateway to Drummoyne village. Light-filled interiors are wrapped in windows on three sides with a loggia-style entertainer's balcony capturing views to the city skyline and Harbour Bridge that come alive at night. Streamlined interiors with Oak floorboards create a stylish feel with lift access to secure parking and cafes, delis, bakeries at the doorstep. Walk to tranquil waterfront parkland and the Bay Run.

- Private setting, one common wall and no apartment above
- Large bedroom with built-ins, 2nd bed or study/nursery
- Open living with Oak floorboards, Daikin reverse cycle air
- Alfresco lounge with views to the city and Harbour Bridge
- Newly updated Smeg gas kitchen, Caesarstone benchtops
- Designer bathroom with a bath, hidden laundry, LED lighting

2



1

1

ADDITIONAL DETAIL

Council Rates	\$288/qtr (approx)
Strata Fees	\$1,123/qtr (approx)
Water Rates	\$147/qtr (approx)
Type	Apartment
Sold Date	16/09/2020

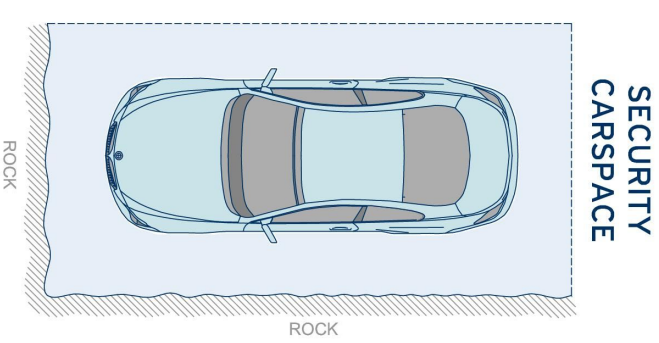
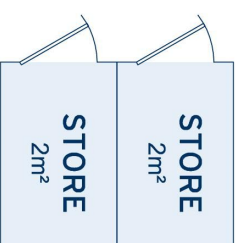
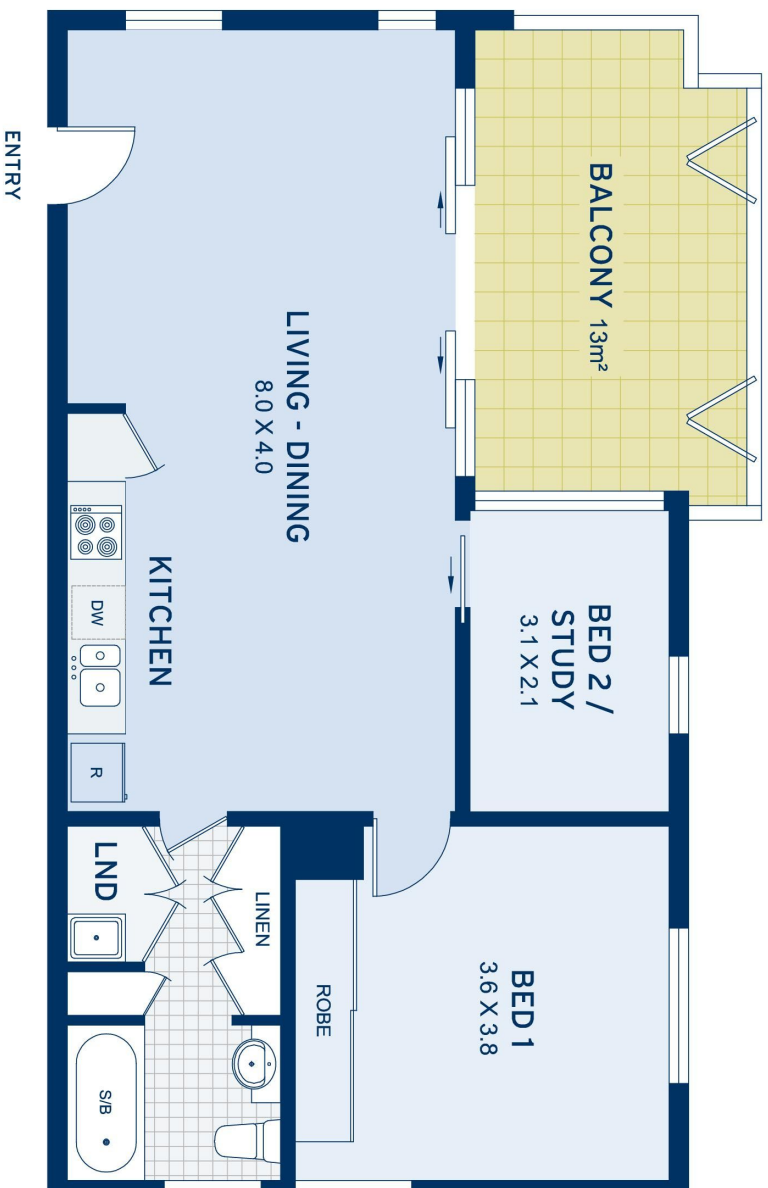
Chad Egan
0408 884 353
chad@ch.com.au



APPROXIMATE AREAS	
Apartment	71sqm
Parking	13sqm
Storerooms	4sqm
Total	88sqm
OUTGOINGS	
Council Rates	\$288 pq
Water Rates	\$147 pq
Strata Rates	\$1123 pq

Drummoyne
310/2 Marlborough Street

DISCLAIMER: This information has been prepared as a guide only. The vendor and the real estate agent, Drummoyne Estate Agency Pty Ltd (trading as Cobden & Hayson Drummoyne), make no warranties as to its accuracy and all interested parties must rely on their own enquiries.

cobden & hayson