

# Balmain

## 8/2 Jubilee Place



**\$1.95m**

## Harbour splendour and waterfront serenity

Panoramic views over picturesque Ewerton Park and the harbour to the bright lights of Barangaroo create a spectacular backdrop to all levels of this waterfront haven. Holding the best position in the tightly held Cameron's Cove, the terrace-like residence is tucked away to the peaceful rear with a choice of outdoor living areas and the park as a virtual extension of its idyllic gardens. The first time offered to the market, the three bedroom home features rear access to double garaging and is 700m to the ferry for an easy commute to the city.

- Prized corner setting and a private landscaped garden entry
- Panoramic views, beautiful by day and captivating by night
- Flexible 3/4 bed layout, huge top floor retreat/2nd living area
- Master with built-ins, a large skylit ensuite and private balcony
- Bright east facing living room flows to a view-swept courtyard
- Caesarstone gas kitchen, dining with an entertainer's terrace

		
<b>3</b>	<b>2</b>	<b>2</b>

### ADDITIONAL DETAIL

Council Rates	\$353/qtr (approx)
Strata Fees	\$1,860/qtr (approx)
Water Rates	\$147/qtr (approx)
Type	Townhouse
Sold Date	19/09/2020

**Ada Mastronardo**  
0410 698 019  
ada@ch.com.au

**Danny Cobden**  
0411 144 210  
danny@ch.com.au

## LEVEL ONE

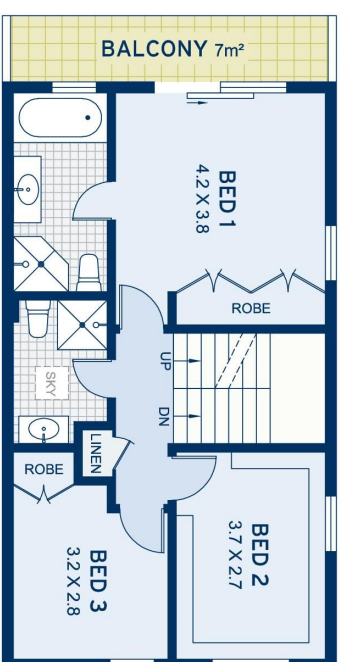

## LEVEL TWO

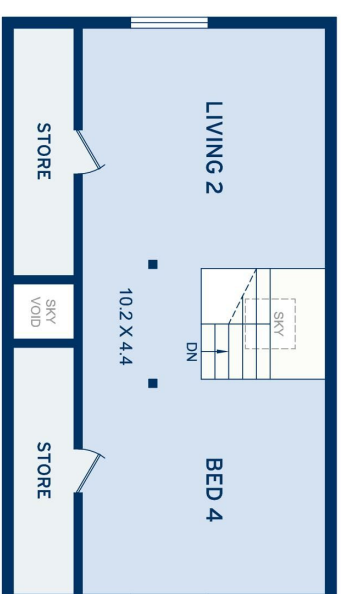

## BASEMENT

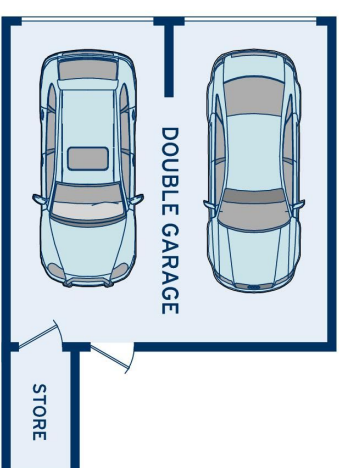

APPROXIMATE AREAS	
Internal Area	160sqm
Garage & Store	34sqm
External	82sqm
Total	276sqm
OUTGOINGS	
Council Rates	\$353 pq
Water Rates	\$147 pq
Strata Rates	\$1860 pq

**Balmain**  
8/2 Jubilee Place

DISCLAIMER: This information has been prepared as a guide only. The vendor and the real estate agent, Balmain Real Estate Pty Ltd and/or Balmain Estate Agency Pty Ltd (trading as Cobden & Hayson Balmain), make no warranties as to its accuracy and all interested parties must rely on their own enquiries.

cobden & hayson