

Leichhardt

7/23 Norton Street



The best value apartment in Leichhardt - Palazzo Firenze

A quiet elevated setting in Norton Street's landmark Italian Forum offers a taste of European-style village living with direct level lift access to every convenience. Offering exceptional value for its size and location, the spacious two-bedroom apartment offers 92sqm of indoor/outdoor living space with a north facing entertainer's terrace and secure undercover parking on title. Built to last and presented in excellent condition, this low-maintenance apartment is ideal for the executive buyer or investor with scope to add value with a cosmetic renovation.

- Level 3, newly upgraded lift, secure parking and a gym
- 2 double bedrooms with built-in robes and 2 bathrooms
- King-sized master bed with an ensuite and dressing area
- Open plan living and dining, modern granite gas kitchen
- Full-width north facing terrace, 20sqm of outdoor space
- Separate internal laundry, reverse cycle air, gas heating



2 2 1

ADDITIONAL DETAIL

Type	Apartment
Sold Date	11/09/2020

Undisclosed

Santos Sulpharo
0402 680 861
santos@ch.com.au

Frank Sulpharo
0410 645 037
franks@ch.com.au

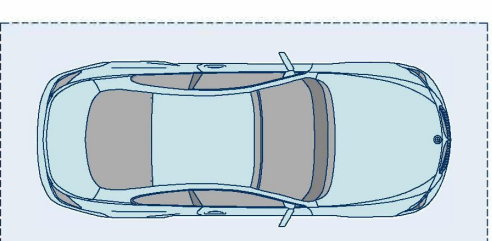
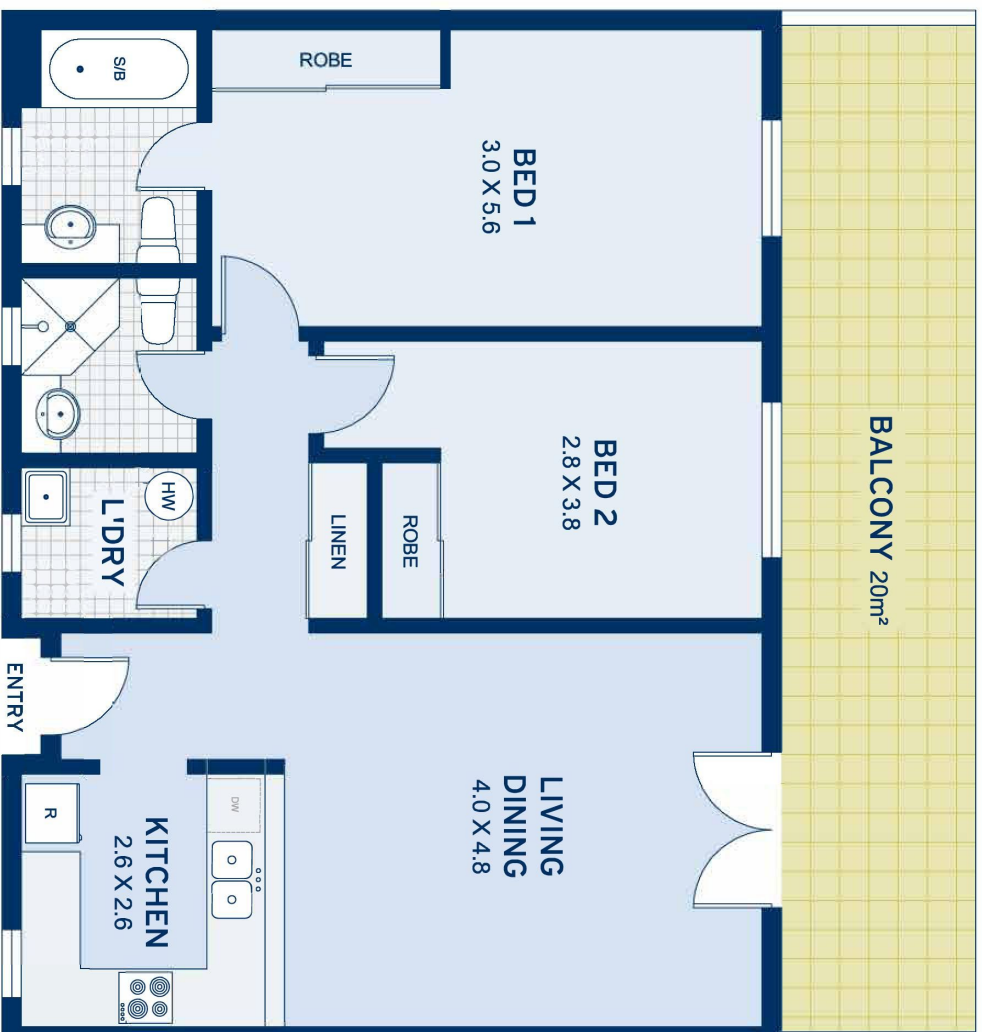

**SECURITY
CARSPACE**



APPROXIMATE AREAS	
Apartment	92sqm
Parking	14sqm
Total	106sqm
OUTGOINGS	
Council Rates	\$300 pq
Water Rates	\$175 pq
Strata Rates	\$1400 pq

Leichhardt
7/23 Norton Street

DISCLAIMER: This information has been prepared as a guide only. The vendor and the real estate agent, Annandale Estate Agency Management Pty Ltd (trading as Cobden & Hayson Annandale), make no warranties as to its accuracy and all interested parties must rely on their own enquiries.

cobden & hayson