

# Chiswick

## 13 Hezlet Street



Undisclosed

## Rare waterfront - on over 1100sqm of land

It's rare to find a waterfront property set on an impressive 1,119 sqm with such untapped potential. Offering astute buyers the opportunity to own or develop a sizeable home, boasting panoramic views over Five Dock Bay and the Gladesville Bridge, and a prestigious peninsula address, this is not to be missed.

- Exciting potential to redevelop large plot size STCA
- Private boat shed & exclusive water access via boat ramp
- Deep lawned garden & established foliage for privacy
- Spacious living area features original open fireplace
- Large covered verandah offers sweeping views of the bay
- Good-sized kitchen, traditional bathroom & separate w/c
- Three double bedrooms all with built in wardrobes
- Under house garage parking for two cars & ample storage

|   |  |   |
|---|--|---|
|  |  |  |
| 3   | 2  | 2   |

### ADDITIONAL DETAIL

|               |                    |
|---------------|--------------------|
| Council Rates | \$953/qtr (approx) |
| Water Rates   | \$147/qtr (approx) |
| Type          | House              |
| Sold Date     | 29/08/2020         |
| Land          | 1119 Square Metres |

**Tim Wieland**  
0414 282 713  
tim@ch.com.au

**Jack Hughes**  
0412 255 711  
jack@ch.com.au

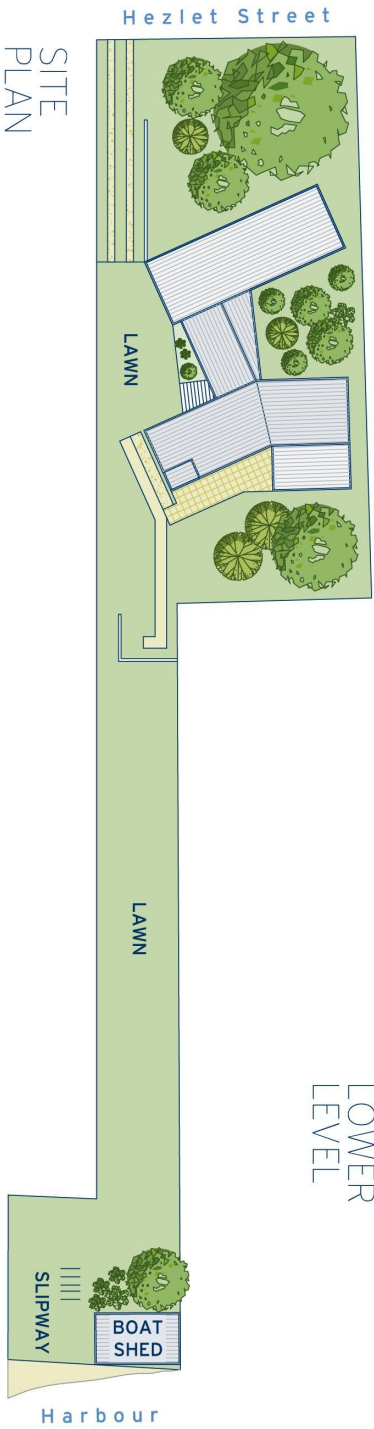
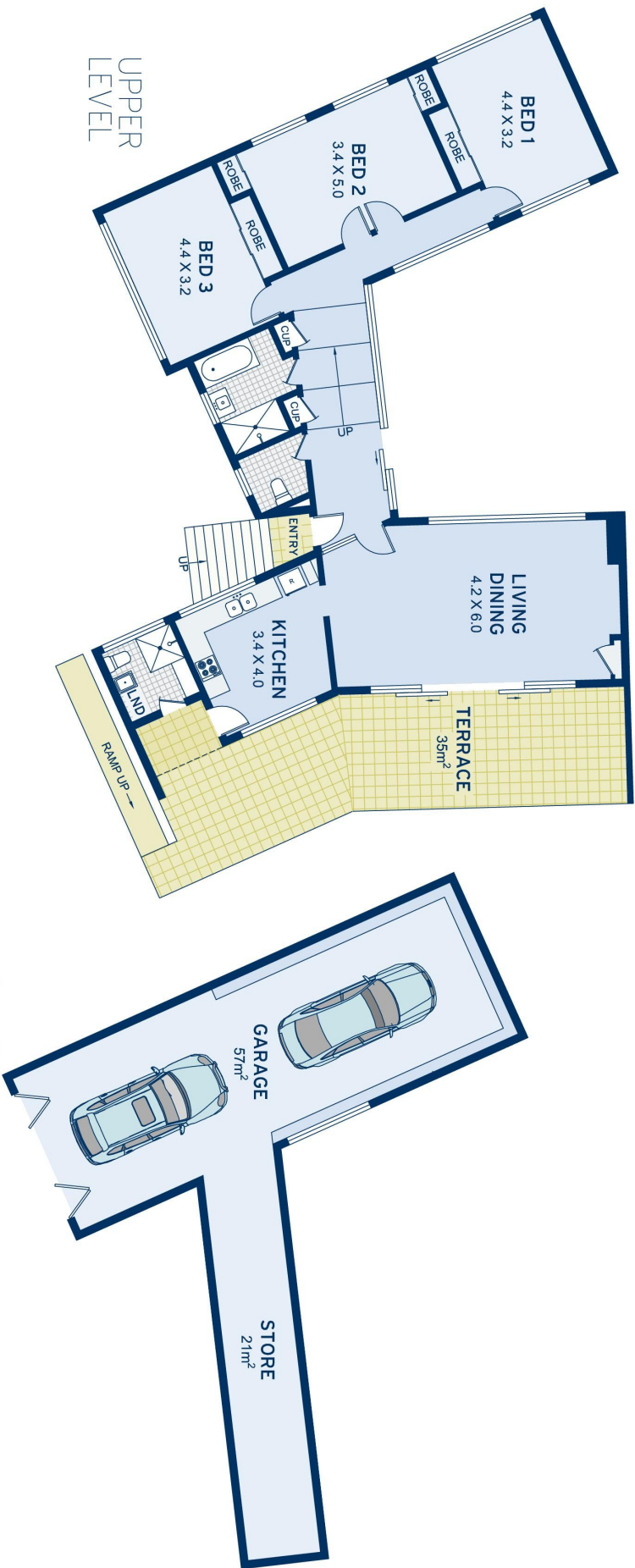

| APPROXIMATE AREAS   |          |
|---------------------|----------|
| Internal FloorSpace | 131sqm   |
| Garage              | 78sqm    |
| Land Size           | 1119sqm  |
| OUTGOINGS           |          |
| Council Rates       | \$953 pq |
| Water Rates         | \$147 pq |

SITE PLAN

**Chiswick**  
13 Hezlet Street

DISCLAIMER: This information has been prepared as a guide only. The vendor and the real estate agent, Drummoyne Estate Agency Pty Ltd (trading as Cobden & Hayson Drummoyne), make no warranties as to its accuracy and all interested parties must rely on their own enquiries.

cobden & hayson