

Sydney

426/27 Park Street



Superb city views from a smart Park Regis apartment

In the ultimate lifestyle location and immersed in a breathtaking city panorama, this sophisticated apartment is ideally situated in the sought-after Park Regis tower, and on the doorstep of Sydney's business, dining and entertainment precinct. Stylish in its design and generous in its layout, it offers peaceful inner-city retreat with light-filled interiors, great air cross-flow and a user-friendly floorplan that takes full advantage of the views.

- Full views over the harbour and city to the Blue Mountains
- Generous and sun-filled open living and dining space
- Two bedrooms include a whisper-quiet main with built-ins
- Well-appointed modern kitchen with internal laundry
- Low energy, quiet, wifi air-conditioners, dimmable lights, good storage
- Rooftop pool with entertainment deck and stunning views
- A quality security building with lift access and intercom

2

1

ADDITIONAL DETAIL

Type
Sold Date

Apartment
03/04/2020

David Carrozza
0411 296 796
david@ch.com.au

Andrew Colagiuri
0408 685 066
andrewc@ch.com.au

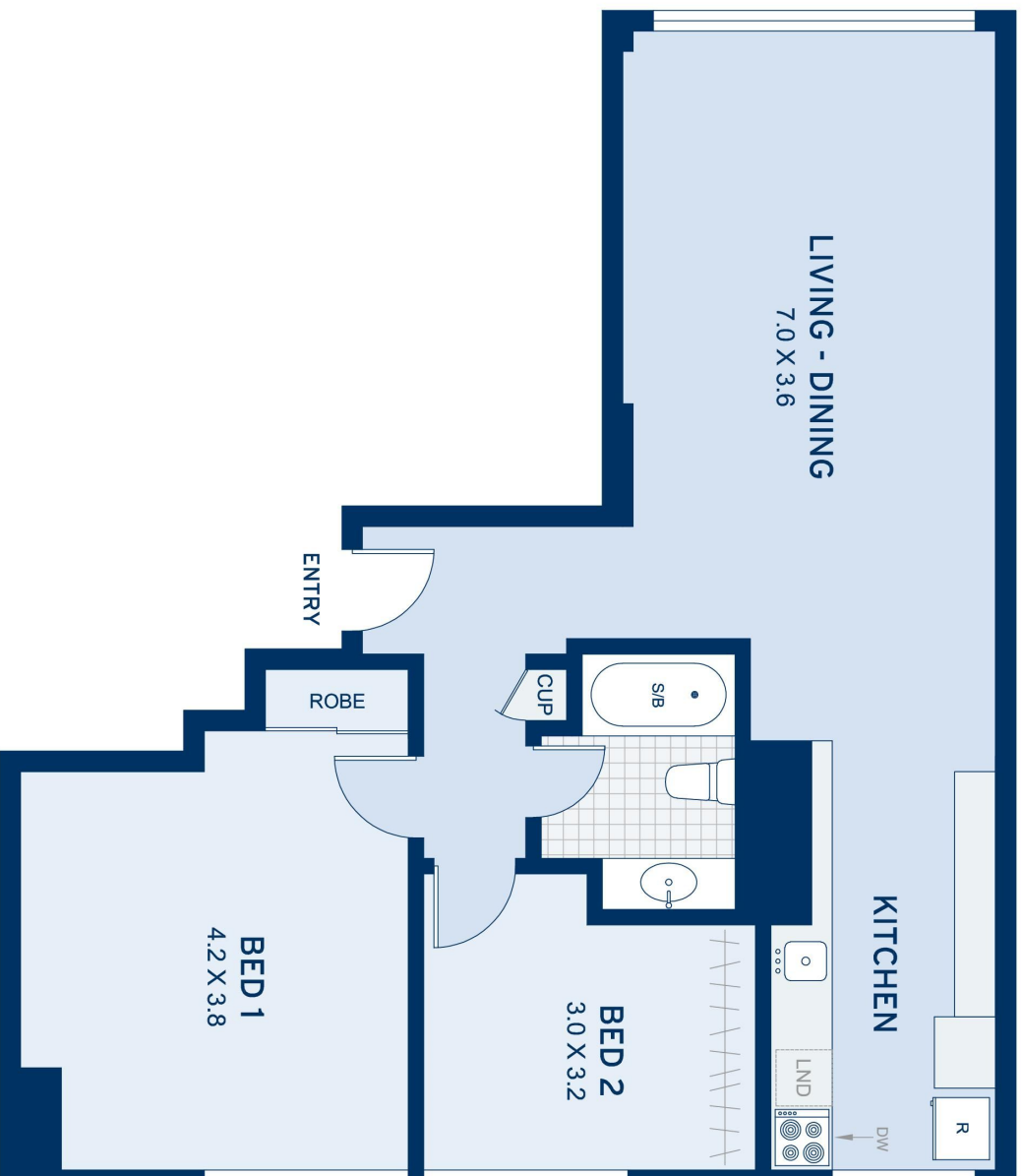

APPROXIMATE AREAS	
Internal Floor Space	72sqm
OUTGOINGS	
Council Rates	\$293 pq
Water Rates	\$184 pq
Strata Rates	\$1305 pq



Sydney
426/27 Park Street

DISCLAIMER: This information has been prepared as a guide only. The vendor and the real estate agent, Annandale Estate Agency Management Pty Ltd (trading as Cobden & Hayson Annandale), make no warranties as to its accuracy and all interested parties must rely on their own enquiries.

cobden & hayson