

# Newtown

## 78 Gowrie Street



## Classic period terrace with a fresh urban feel

Offering a fresh and bright style that perfectly balances its traditional appeal, this classic terrace offers a private retreat central to the best of Newtown and Erskineville. It features a bright dual level layout with good quality finishes throughout and a focus on low maintenance living. When it comes to convenience and lifestyle you can't go past this vibrant location that has King Street's dining options, Erskineville village and a choice of train stations and parks all easily accessible on foot.

- Crisp interiors feature an open lounge and dining area
- Wide polished floors, high ceilings and two fireplaces
- Private rear courtyard and paved entertainment area
- Lock-up garage with storage space and rear lane access
- Upstairs bedrooms include a main with built-ins & balcony
- Modern skylit kitchen fitted with stainless gas fittings
- Updated bathroom plus laundry with workshop/storage

		
2	1	1

### ADDITIONAL DETAIL

Council Rates	\$311/qtr (approx)
Water Rates	\$285/qtr (approx)
Type	House
Sold Date	21/06/2019

**Jim Nikolopoulos**  
0406 626 663  
jim@ch.com.au

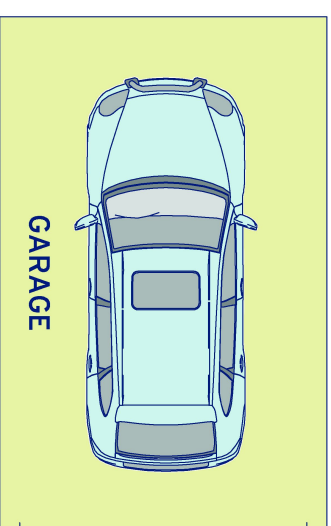
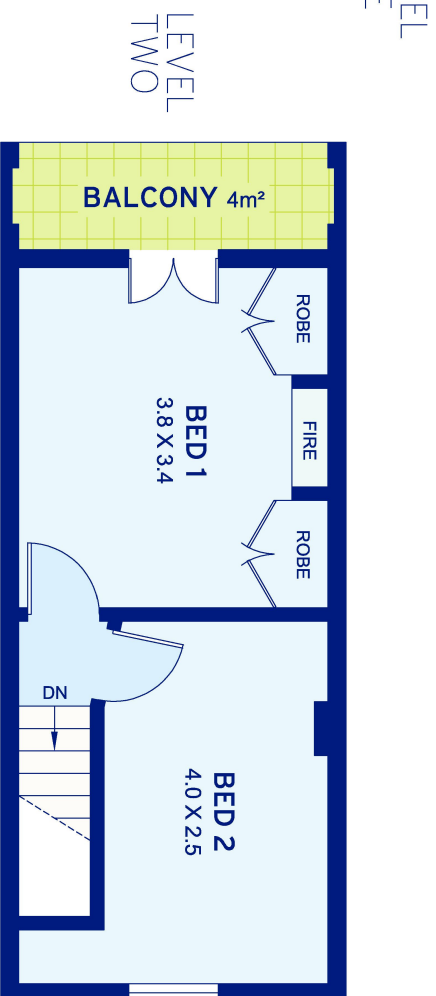
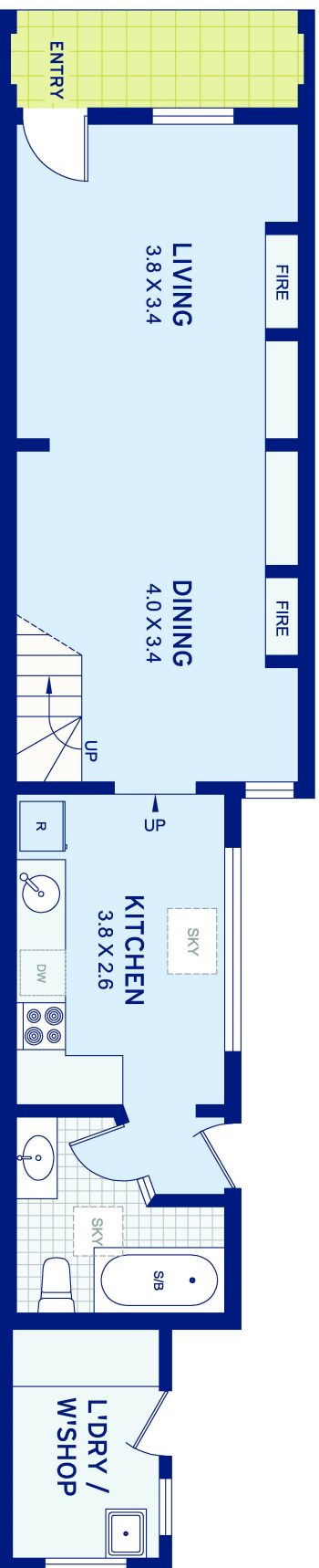

SITE  
PLAN

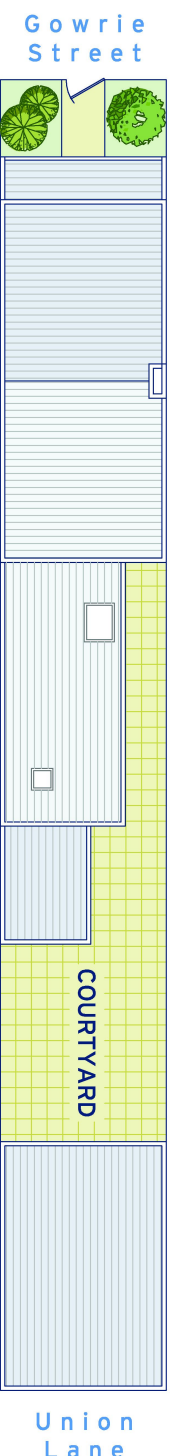

APPROXIMATE AREAS	
Internal FloorSpace	75sqm
Garage	21sqm
External	44sqm
Land Size	108sqm
OUTGOINGS	
Council Rates	\$311 pq
Water Rates	\$285 pq

**Newtown**  
78 Gowrie Street

DISCLAIMER: This information has been prepared as a guide only. The vendor and the real estate agent, The IW Agency Pty Ltd (trading as Cobden & Hayson Earwood/Marrickville), make no warranties as to its accuracy and all interested parties must rely on their own enquiries.

cobden & hayson