

Earlwood

17 Lovat Avenue



Undisclosed

Stunning period home with cottage appeal

A vision in period style and Art Deco splendour, this fine traditional home rests high-side at the end of an exclusive cul-de-sac enjoying the brilliance of a north facing aspect and striking district views to match. Interiors are bright and uplifting adorned with all the elegance of its past whilst offering a relaxed single level floorplan. Stroll to the bus, rail, village shops and Cooks River Parklands

- Private and secure, 765sqm block with sprawling lawns
- Timber floors, high ornate ceilings, leadlight features
- Central lounge, domed ceiling, a/c, fireplace, plate rails
- Separate dining, modern stone topped gas kitchen
- Alfresco terrace, fruit trees, veggie and herb garden
- Generous bedrooms, two with robes, outside toilet
- Perfect as is with scope to extend, double garage



ADDITIONAL DETAIL

| | |
|---------------|--------------------|
| Council Rates | \$614/qtr (approx) |
| Water Rates | \$247/qtr (approx) |
| Type | House |
| Sold Date | 08/11/2018 |
| Land | 765 Square Metres |

Kelly Petrini

kelly@ch.com.au

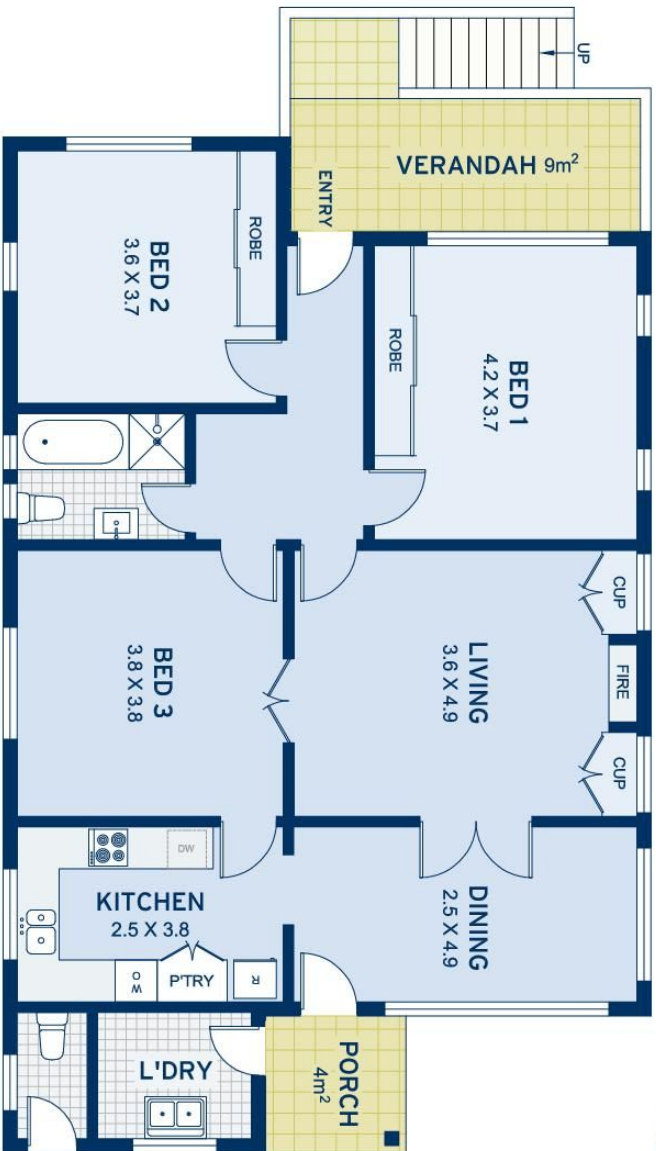
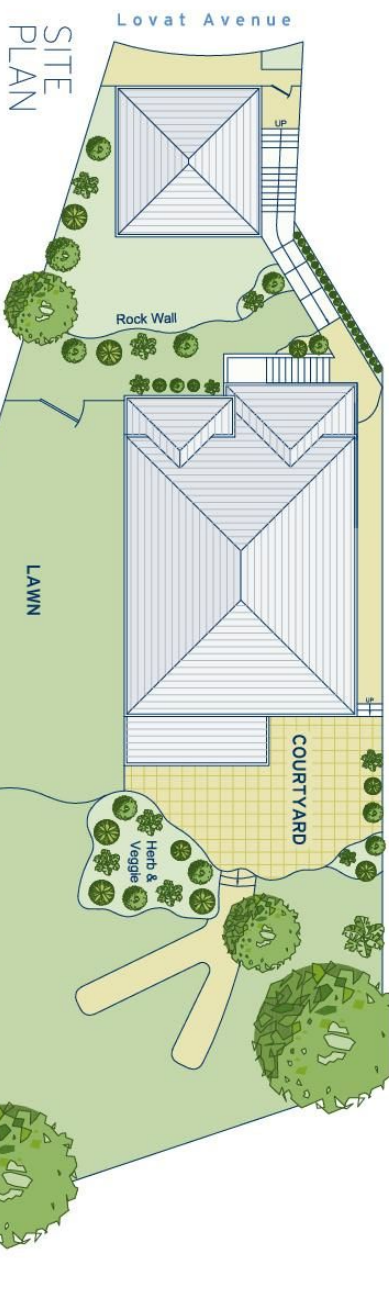
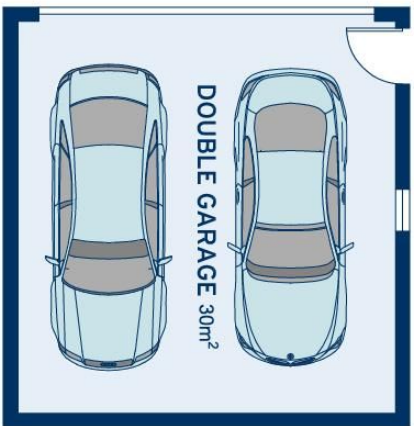

| APPROXIMATE AREAS | |
|----------------------|----------|
| Internal Floor/space | 115sqm |
| Garage | 30sqm |
| External | 620sqm |
| Land Size | 765sqm |
| OUTGOINGS | |
| Council Rates | \$614 pq |
| Water Rates | \$247 pq |

Earlwood
17 Lovat Avenue

DISCLAIMER: This information has been prepared as a guide only. The vendor and the real estate agent, Balmain Real Estate Pty Ltd and/or Balmain Estate Agency Pty Ltd (trading as Cobden & Hayson Balmain), make no warranties as to its accuracy and all interested parties must rely on their own enquiries.