

Annandale

176 Annandale Street



Undisclosed

A masterpiece of contemporary design

Victorian grandeur and state-of-the-art design are showcased in perfect harmony in this architect-reinvented 1890s residence. Built to discerning standards, it spans two levels of high-end designer luxury and opens to a deep landscaped garden with versatile self-contained studio and rear access to double garaging.

- * Freestanding terrace recreated by Level Orange Architects
- * Sophisticated open living areas, limewashed timber floors
- * 4 large beds, custom satin poly built-ins, integrated study
- * Glamorous master suite with dressing room and balcony
- * High-spec entertainer's island kitchen, Gaggenau appliances
- * Blackbutt deck, integrated bbq, level landscaped garden
- * Luxurious European appointed baths, underfloor heating
- * Private guest suite or home office, RLA to double carport
- * Chic powder room, zoned air, 3 restored fireplaces, alarm

		
4	3	2

ADDITIONAL DETAIL

Council Rates	\$568/qtr (approx)
Water Rates	\$266/qtr (approx)
Type	House
Sold Date	27/03/2015
Land	314 Square Metres

Ben Southwell
0407 896 212
bens@ch.com.au

Matthew Hayson
0411 519 190
matth@ch.com.au

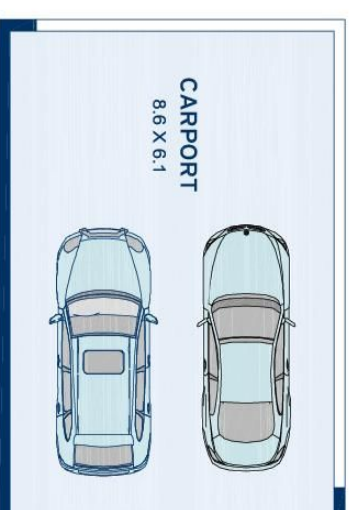
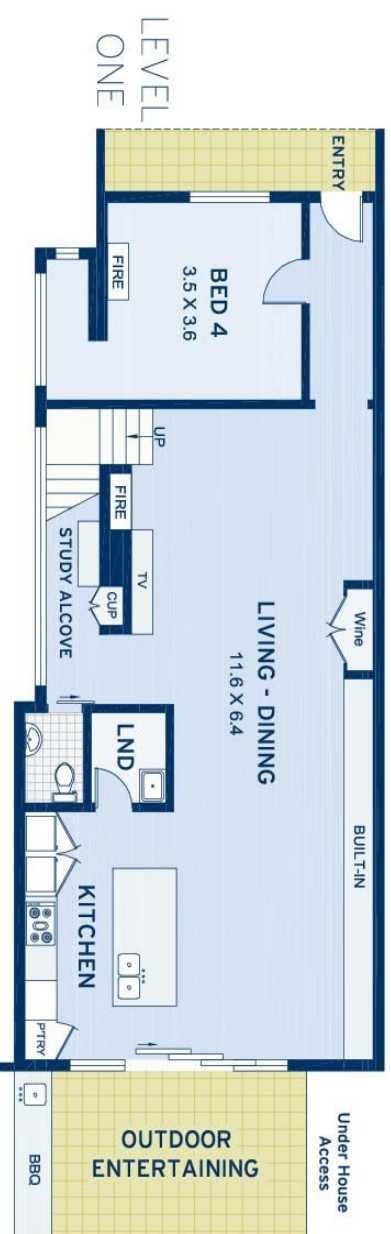
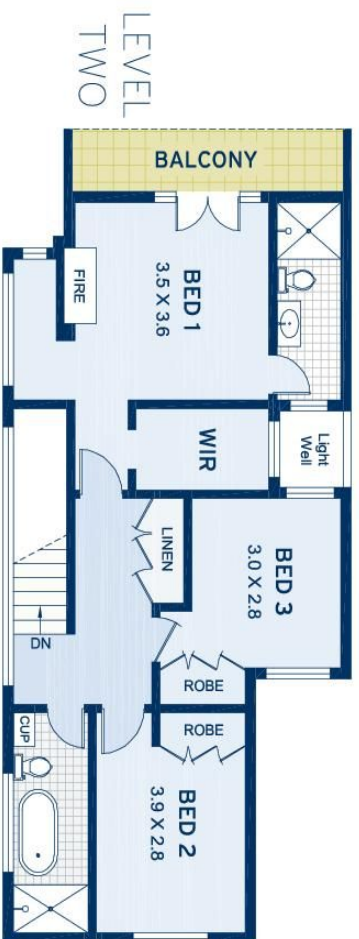

APPROXIMATE AREAS	
Internal Floorspace	174sqm
Carport	52sqm
Studio	22sqm
External	130sqm
Land Size	314sqm
OUTGOINGS	
Council Rates	\$568 pa
Water Rates	\$266 pa



Annandale
176 Annandale Street

DISCLAIMER: This information has been prepared as a guide only. The vendor and the real estate agent, Balmain Real Estate Pty Ltd and/or Balmain Estate Agency Pty Ltd (trading as Cobden & Heyson), make no warranties as to its accuracy and all interested parties must rely on their own enquiries.

cobden & hayson