

# Waterloo

## 1023/2 Lachlan Street

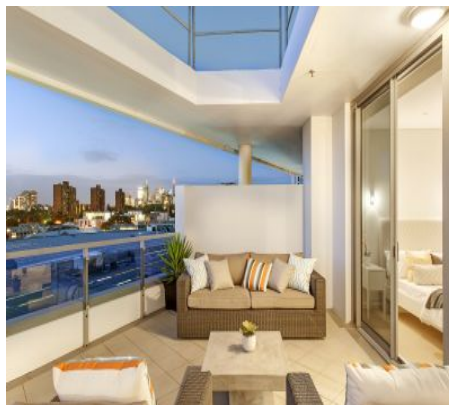

## The height of urban luxury

The crowning glory of the acclaimed Aria building, this luxurious penthouse is wrapped in a private roof terrace with expansive urban views creating a dazzling backdrop for entertaining. Located in a city fringe hot spot on the edge of Green Square, it's a short stroll to Danks Street and the new East Village hub.

- Floor to ceiling glass frames panoramic 270 degree views
- 3 double beds with built-ins and direct terrace access
- Master with spa ensuite, designer baths, internal laundry
- Expansive living and dining, enormous rooftop terrace
- Entertainer's CaesarStone gas kitchen, Miele appliances
- Double garaging plus storage, resort-style pool and gym
- Lift access, full security, 204sqm of indoor/outdoor living
- Mins to the city and beaches, on-site cafes and eateries



3

2

2

\$1.27m

## ADDITIONAL DETAIL

Council Rates	\$202/qtr (approx)
Strata Fees	\$2,392/qtr (approx)
Water Rates	\$170/qtr (approx)
Type	Apartment
Sold Date	30/03/2015
Land	234 Square Metres

Kelly Petrini

kelly@ch.com.au

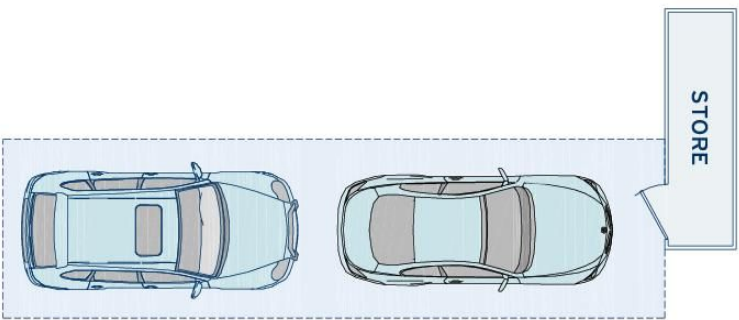

APPROXIMATE AREAS	
Internal Floor-space	126sqm
Parking & Store	30sqm
External	78sqm
<b>Total</b>	<b>234sqm</b>
OUTGOINGS	
Council Rates	\$202 pq
Water Rates	\$170 pq
Strata Rates	\$2392 pq

**Waterloo**  
1023/2 Lachlan Street

DISCLAIMER: This information has been prepared as a guide only. The vendor and the real estate agent, Balmain Real Estate Pty Ltd and/or Balmain Estate Agency Pty Ltd (trading as Cobden & Hayson), make no warranties as to its accuracy and all interested parties must rely on their own enquiries.

**cobden & hayson**